

GROUND NOTES LEGEND

- | <u>MARK</u> | <u>MARK DESCRIPTION</u> |
|-------------|---|
| A | 4/0 GROUND CONDUCTOR FROM GROUND LOOP TO 5'-0" OUTSIDE OF BUILDING SLAB. |
| B | 4/0 INSULATED GROUND CONDUCTOR FROM GROUND GRID TO COLUMN. WILL BE 12" A.F.F.. 4/0 CONDUCTOR TO A COLUMN WILL BE 12" A.F.F.. 4/0 CONDUCTOR TO PENETRATE SLAB VIA 3/4" RIGID COUPLING AND ROMEX CONNECTOR WELDED TO COLUMN INBED BASE. |
| C | 3/4"Ø x 10'-0" COPPER CLAD GROUND ROD ATTACHED TO 4/0 GROUND GRID. |
| D | #4 SOLID COPPER CADWELD TO 4/0 LOOP AND CONNECTED TO TANK RING VIA 3/8" STUD WELDED TO RING. |

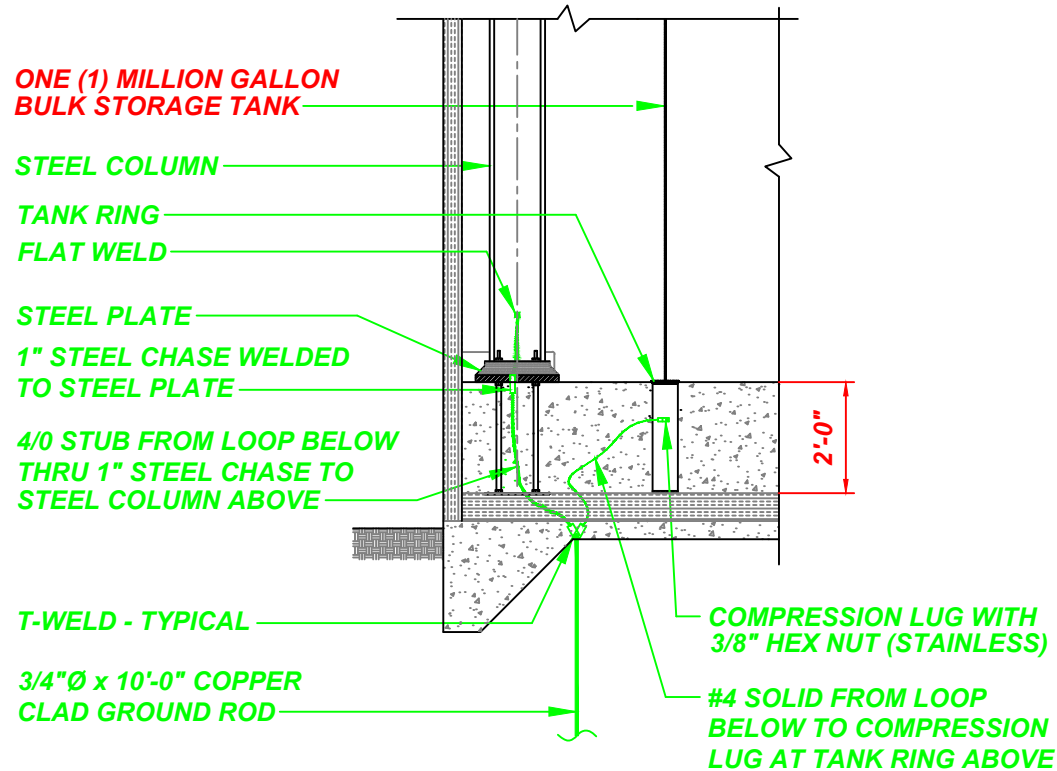

COLUMN & TANK RING GROUNDING DETAIL

SCALE:

3/8"=1'-0"